

Viti con impugnatura• DIN 6335 in plastica EH 24730.



Descrizione prodotto

Materiale

Impugnatura
• DIN 7708 - Plastica (PF 31), nero RAL 9005

Vite
• Acciaio, zincato
• Acciaio inox A2

Maggiori informazioni

Note

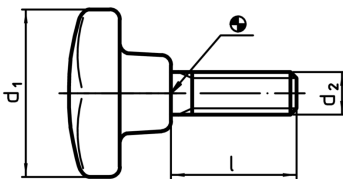

Esecuzioni speciali, p. es. con viti di lunghezza particolare o diverso materiale (ottone, acciaio inox), sono approntabili a richiesta.

Disegno



Caratteristiche

d ₁	Dimensioni		l	max. [°C]	[g]	Cod.
	d ₂ [mm]					
Forma L, Acciaio						
25	M 5		10	110	6,7	24730.0051
25	M 5		15	110	7,0	24730.0053
25	M 5		20	110	7,5	24730.0056
25	M 5		25	110	8,1	24730.0058
25	M 5		30	110	8,9	24730.0059
32	M 6		15	110	11,0	24730.0101
32	M 6		20	110	12,0	24730.0104
32	M 6		25	110	15,0	24730.0106
32	M 6		30	110	16,0	24730.0107
32	M 6		40	110	16,0	24730.0110
40	M 8		20	110	24,0	24730.0152
40	M 8		25	110	25,0	24730.0154
40	M 8		30	110	26,0	24730.0155
40	M 8		40	110	30,0	24730.0158
40	M 8		50	110	32,0	24730.0160
50	M10		25	110	41,0	24730.0202
50	M10		30	110	48,0	24730.0203
50	M10		40	110	51,0	24730.0206
50	M10		50	110	56,0	24730.0208
50	M10		60	110	68,0	24730.0209
63	M12		30	110	86,0	24730.0251
63	M12		40	110	93,0	24730.0254
63	M12		50	110	99,0	24730.0256
63	M12		60	110	105,0	24730.0257
63	M12		80	110	112,0	24730.0260
80	M16		40	110	198,0	24730.0302
80	M16		50	110	175,0	24730.0304
80	M16		60	110	219,0	24730.0305
80	M16		80	110	251,0	24730.0308

d ₁	Dimensioni		I	 max. [°C]	 [g]	Cod.
	d ₂ [mm]					
Forma L, Acciaio inox						
25	M 5		10	110	6,7	24730.1051
25	M 5		15	110	7,0	24730.1053
25	M 5		20	110	7,5	24730.1056
25	M 5		25	110	8,1	24730.1058
25	M 5		30	110	8,9	24730.1059
32	M 6		15	110	11,0	24730.1101
32	M 6		20	110	12,0	24730.1104
32	M 6		25	110	15,0	24730.1106
32	M 6		30	110	16,0	24730.1107
32	M 6		40	110	16,0	24730.1110
40	M 8		20	110	24,0	24730.1152
40	M 8		25	110	25,0	24730.1154
40	M 8		30	110	26,0	24730.1155
40	M 8		40	110	30,0	24730.1158
40	M 8		50	110	32,0	24730.1160
50	M10		25	110	41,0	24730.1202
50	M10		30	110	48,0	24730.1203
50	M10		40	110	51,0	24730.1206
50	M10		50	110	56,0	24730.1208
50	M10		60	110	68,0	24730.1209
63	M12		30	110	86,0	24730.1251
63	M12		40	110	93,0	24730.1254
63	M12		50	110	99,0	24730.1256
63	M12		60	110	105,0	24730.1257
63	M12		80	110	112,0	24730.1260
80	M16		40	110	198,0	24730.1302
80	M16		50	110	175,0	24730.1304
80	M16		60	110	219,0	24730.1305
80	M16		80	110	251,0	24730.1308