

Pomelli a croce· DIN 6335 in plastica EH 24640.



Descrizione prodotto

Materiale

- Bussola
- Ottone
 - Acciaio, zincato
 - Acciaio inox A2

Impugnatura

- DIN 7708 - Plastica (PF 31), nero RAL 9005

Disegno

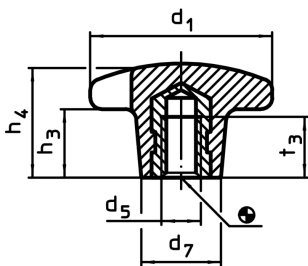

Caratteristiche

Dimensioni						max. [°C]	[g]	Cod.
d ₁	d ₅	d ₇	h ₃	h ₄	t ₃			
Con bussola filettata, forma K, Ottone								
20	M 4	10	6	13	6,5	110	3,3	24640.0220
Con bussola filettata, forma K, Acciaio								
25	M 5	12	8	16	9,5	110	7,0	24640.0225
32	M 6	14	10	20	12,0	110	12,0	24640.0232
40	M 8	18	13	25	14,0	110	16,0	24640.0240
50	M10	22	20	32	18,0	110	32,0	24640.0250
63	M12	26	25	40	22,0	110	62,0	24640.0263
80	M16	35	30	50	30,0	110	137,0	24640.0280
Con bussola filettata, forma K, Acciaio inox								
25	M 5	12	8	16	9,5	110	7,0	24640.1225
32	M 6	14	10	20	12,0	110	12,0	24640.1232
40	M 8	18	13	25	14,0	110	16,0	24640.1240
50	M10	22	20	32	18,0	110	32,0	24640.1250
63	M12	26	25	40	22,0	110	62,0	24640.1263
80	M16	35	30	50	30,0	110	137,0	24640.1280

Esempio di applicazione

