

Pomoli conici
EH 24550.

Descrizione prodotto



Materiale

- Termoplastica (PF 31), nera

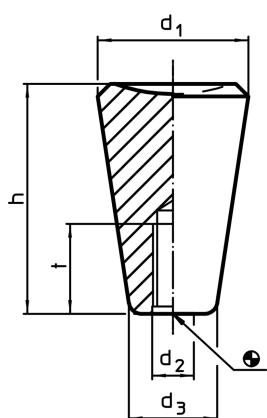
Disegno



Caratteristiche

d ₁	d ₂	Dimensioni			t min.	 max. [°C]	 [g]	Cod.
		d ₃ ~ [mm]	h					
20	M 5	12	30	18	110	7,8	24550.0010	
20	M 6	12	30	18	110	7,4	24550.0011	
25	M 6	15	38	18	110	14,0	24550.0020	
25	M 8	15	38	18	110	13,0	24550.0021	
30	M 8	18	46	18	110	26,0	24550.0030	
30	M10	18	46	18	110	25,0	24550.0031	
35	M10	21	53	21	110	46,0	24550.0040	
35	M12	21	53	21	110	43,0	24550.0041	

Esempio di applicazione

